

DATE: OCTOBER 1992

PAGE: 1 of 8

REF: JD 16/92

## ERRATA

Owing to revised information, the torque figure for the coolant temperature transmitter to engine, XJS models, is 14,5 to 19,5 Nm.

The torque figure given in Service Bulletin JD 10/92 and Section 88 of XJS Service Manual, JJM 10 04 06/20, should be ignored and only the revised figure used.

Service Manuals will be amended at the next reprint.

**XJ6 93 MY (FROM VIN 667829)**

**ITEM: 44**

### BATTERY TRANSIT RELAY – REMOVAL

Owing to the relocation of the battery into the boot at 93 MY, a revised battery transit relay has been introduced, (see Fig 1).

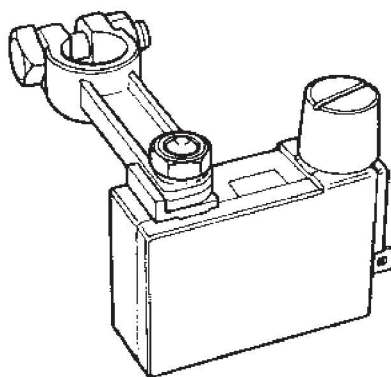

JSF-1773

FIG 1

The procedure for the removal of this new relay is as follows:

#### WITH THE IGNITION OFF:

1. Open the boot and remove the battery cover, (see Fig 2).
2. Remove the negative lead from the battery.
3. Disconnect the transit relay from the battery.
4. Remove the white / yellow (W/Y) ignition wire from the transit relay.

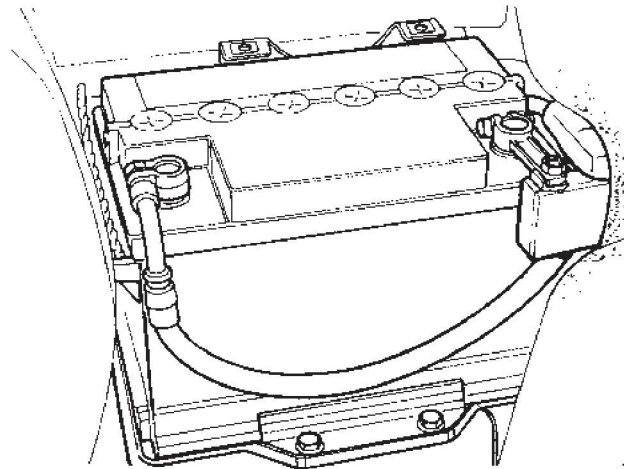

J51 177B

FIG 2

5. Remove the positive lead from the transit relay terminal post, (A, Fig 3).
6. Reverse the positive lead clamp and refit the clamp to the positive lead (B, Fig 3).

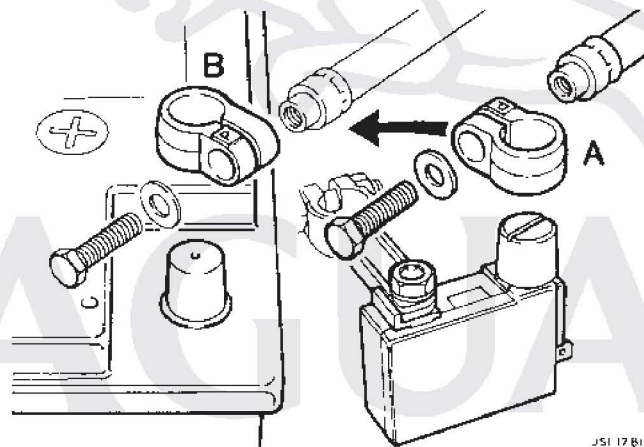

J51 178A

FIG 3

7. Displace the battery.
8. Tie back and secure the white / yellow (W/Y) ignition wire, (see Fig 4).

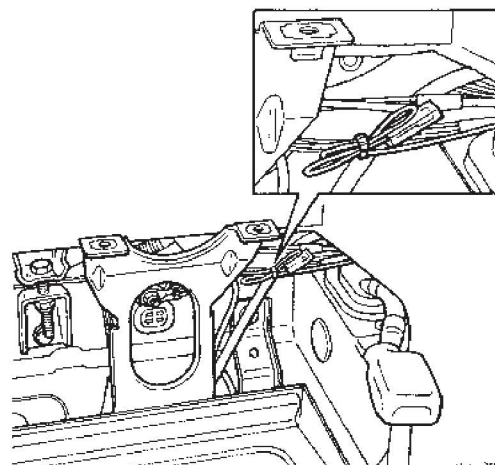

J51 179A

FIG 4

9. Refit the battery.
10. Refit and secure the positive and then negative lead of the battery.
11. Replace the battery cover.

**NOTE: ALL UK DEALERS MUST CONTINUE TO RETURN THE DISPLACED TRANSIT RELAYS.**

**REMOVAL OF THE TRANSIT RELAY SHOULD BE CARRIED OUT NO LONGER THAN 24 HOURS BEFORE THE VEHICLE IS HANDED OVER TO THE CUSTOMER.**

**THE RADIO AND TIME CLOCK MUST BE RESET AFTER THE RELAY IS REMOVED.**

**IMPORTANT: UNDER NO CIRCUMSTANCES SHOULD THE RELAY BE USED OR RETAINED AS AN ISOLATION DEVICE FOR ROAD USE.**

XJS

ITEM: 45

### 03 REPAIR OPERATION TIMES

#### Air Conditioning Blower Motor Assembly

The repair operation times for renewing the air conditioning blower motor assemblies have been re-studied on 1992 MY vehicles.

The new operation times for vehicles from VIN 179737 are as follows:

#### Right-hand drive vehicles

82-25-13	Blower Assembly – Left-Hand – Renew	0.95 Hrs
82-25-13/09	As 82-25-13 (Less JDS Allowance)	0.60 Hrs
82-25-14	Blower Assembly – Right-Hand – Renew	1.60 Hrs
82-25-14/09	As 82-25-14 (Less JDS Allowance)	1.25 Hrs

#### Left-hand drive vehicles

82-25-13	Blower Assembly – Left-Hand – Renew	1.60 Hrs
82-25-13/09	As 82-25-13 (Less JDS Allowance)	1.25 Hrs
82-25-14	Blower Assembly – Right-Hand – Renew	0.95 Hrs
82-25-14/09	As 82-25-14 (Less JDS Allowance)	0.60 Hrs

Please amend your repair times accordingly.

No other repair times are affected.

**XJ6 / XJS****ITEM: 46****10 BRAKE SYSTEM SERVICE RECOMMENDATIONS**

**Note:** This bulletin supersedes Item 21 of Service Bulletin JD 03/92.

With the introduction of the ABS brake system, from the following VINs, the brake servicing recommendations have changed:

1. XJ6 from VIN 594576.
2. XJS (5.3 convertible) from VIN 147269.
3. XJS (5.3 coupe) from VIN 148782.
4. XJS (3.6 coupe) from VIN 148945.

No routine replacement of system seals is necessary. The system and components, which are sealed for life, require no maintenance. Repair is by replacement.

The braking system must still be inspected for satisfactory operation and condition at the regular service intervals.

Because of its hygroscopic nature, brake fluid must be renewed at 2 year or 30 000 mile (48 000 km) intervals, whichever is sooner.

**XJ6 ALL MODELS****ITEM: 47****18 LAMBDA SENSOR SPLASH-SHIELD**

Following reports of the intermittent display of "Fuel Failure 44" on the instrument pack, it was found that this symptom could be caused by water penetrating the lambda sensor.

A lambda sensor splash-shield has been introduced from VIN 664941, which can be fitted retrospectively and should be installed whenever a lambda sensor is changed. This will reduce the possibility of water ingress.

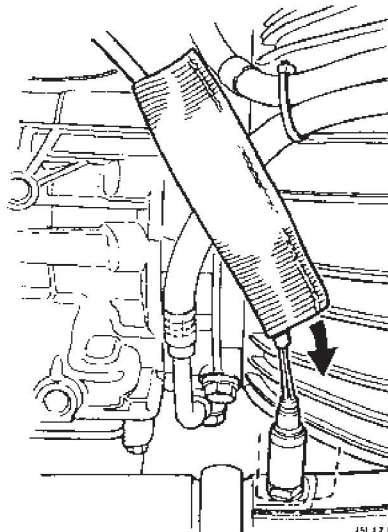

SLEEVE  
C. 33139/4